



YOSHIMURA

RESEARCH&DEVELOPMENT OF AMERICA, INC.

5420 DANIELS STREET STE A, CHINO CA., 91710 · (800) 634-9166 · (909) 628-4722 · FAX (909) 591-2198

www.yoshimura-rd.com

RACE SERIES

Qualified Manufacturer Declared "Modified Part"

2016~2017
Husqvarna
701 Enduro
Supermoto

2014~2017
KTM
690 Enduro R

19701BD520 (SS/CF)
Stainless Steel R-77 Slip-On

FOR CLOSED COURSE COMPETITION ONLY; NOT INTENDED FOR STREET USE

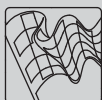

Race Series systems are:

- NOT CARB/EPA tail-pipe emissions compliant.
- NOT street legal.
- For "Closed Course Competition" use only.

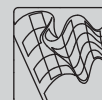

You must know how to remove and replace your stock exhaust in order to install this product otherwise have it installed by a professional mechanic. Keep all stock parts from your existing system as some components may be necessary to install your new Yoshimura exhaust depending on the application. Read through all instructions before beginning installation. Exhaust system can be extremely hot. Let motorcycle cool down before beginning installation. Always wear hand and eye protection and take precautionary measures to avoid injury.



NOTE: IN THE STATE OF CALIFORNIA, IT IS ILLEGAL TO MODIFY THE EMISSION CONTROL SYSTEM, WHICH INCLUDES THE CARBURETORS OF ANY VEHICLE.

Assembly Diagram

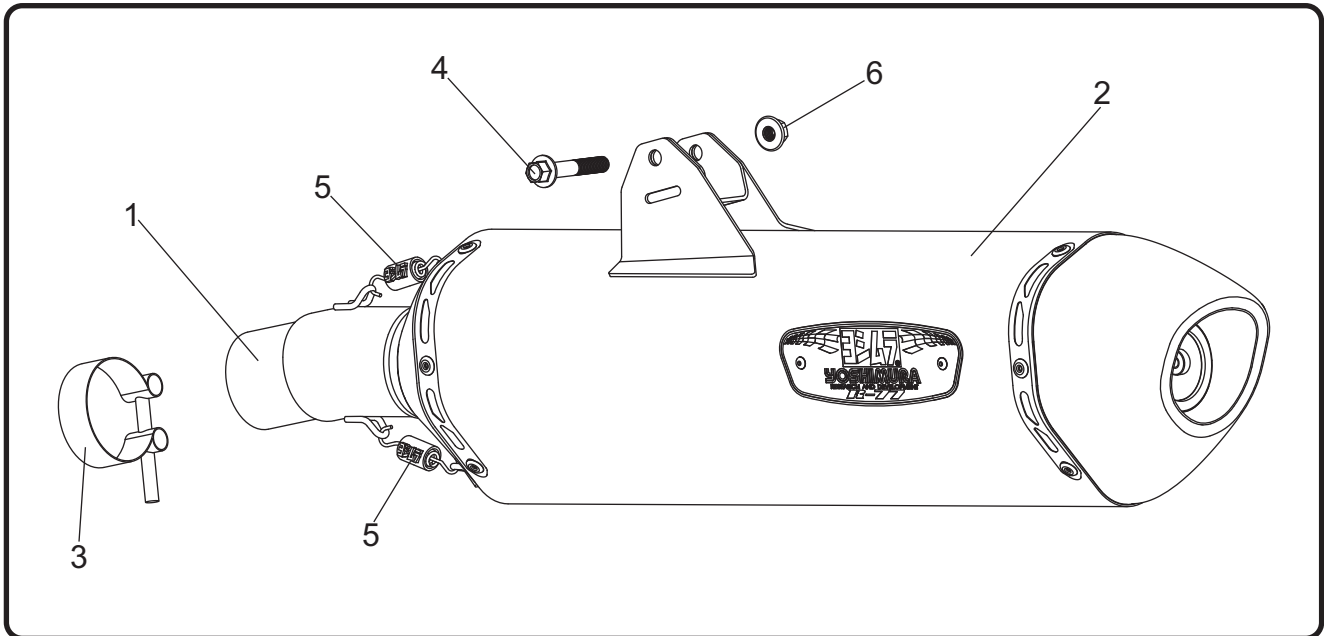

No.	Item	Description	Qty.
1	19701-435	Yoshimura Tailpipe	1
2	19701BD520-LMA	Yoshimura Muffler Assembly	1
3	20062	Exhaust Clamp	1
4	M8X50H	8mm x 50mm Flanged Hex Head Bolt	1
5	RACE-SPS-1	Medium Exhaust Spring	2
6	8MMNUT	8mm Flange Nut	1
**	SA-16-K	Spark Arrester Kit	1
**	ST-200	Spring Puller Tool	1
**	17029	Sticker Sheet	1

** Not Shown on diagram.

CAUTION: Exhaust system can be extremely hot. Let motorcycle cool down before beginning installation. Always wear hand and eye protection and take precautionary measures to avoid injury.

WARNING: Always properly support vehicle with a stand and/or lift when servicing or performing any work. Unstable vehicles may present dangerous conditions and may cause property damage and/or personal injury.

NOTE: Read through all instructions before beginning installation.

Removal

1. Remove rider seat.
2. For Husqvarna 701, follow installation steps "a". For KTM 690, follow installation steps "b".

- 2a. Remove the three header heatshield bolts and remove heatshield.

Note: There are two tabs on the heatshield with rubber sleeves that clip into the left side panel.

- 2b. Remove the two muffler heatshield bolts and remove heatshield. Remove fuel filler cap and disconnect fuel breather hose. Remove the four bolts and three screws securing the upper rear fender.

Note: The three screws are located underneath the license plate holder.

- 3a. Remove left side panel by removing the bolt on the top rear by the rear fender. Carefully pull side panel outward and slide forward to remove.
- 3b. Slide upper rear fender cover forward to clear fuel breather nipple and remove.
4. Loosen muffler exhaust clamp and while securely supporting the stock muffler, remove muffler mount bolt and carefully remove the stock muffler assembly.

Note: The exhaust gasket will not be re-used with the Yoshimura slip-on system.

Installation

1. Slide (No. 3) 20062, exhaust clamp over (No. 1) 19701-435, tailpipe inlet. Do not torque at this time.

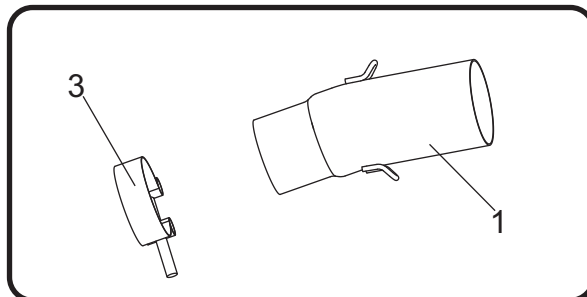

2. Install (No. 1) 19701-435, tailpipe outlet into muffler inlet.
3. Install muffler/tailpipe assembly over the stock header outlet while simultaneously aligning muffler bracket to muffler mount. Secure using (No. 4) M8X50H, 8mm bolt and (No. 6) 8MMNUT, 8mm flange nut. Torque to factory specification.

Note¹: The two stock muffler mount collars must be re-used.

Note²: Muffler mount installs between the muffler bracket.

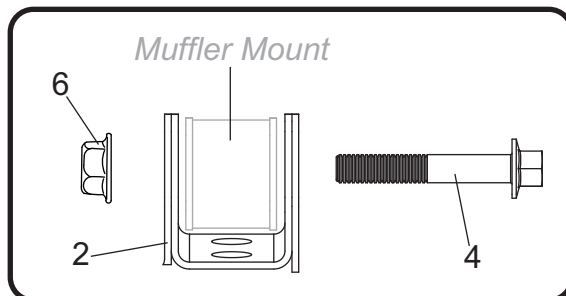

4. Torque (No. 3) 20062, exhaust clamp to 8.5 Nm (6 ft-lb, 0.86 kg-m).
5. Install (No. 5) RACE-SPS-1, medium exhaust springs between muffler and tailpipe using the ST-200, spring puller tool supplied in the kit.
- 6a. Re-install left side panel.
- 6b. Re-install upper rear fender and fuel filler cap.
- 7a. Re-install header heatshield. Check to make sure heatshield tabs are secured in the side panel slots.
- 7b. The stock muffler heatshield will not be re-used.
8. Re-install rider seat.

9. Before starting vehicle, check for proper clearance between new exhaust system and rear suspension (i.e. tire, swingarm, brakes, rear shock, and etc.) If any problem is found, please carefully follow through the installation steps again. If problem still persists, please call Yoshimura Tech Department at (800) 634-9166 / in CA (909) 628-4722.
10. It is recommended that the muffler and tailpipe be wiped down with rubbing alcohol to remove oil and fingerprints. This will help prevent tarnishing of the finish after the exhaust is heated up.

Note: After starting motorcycle, it is normal for new exhaust system and muffler to emit smoke until oil residue burns off.

Works Finish Care & Maintenance

Before starting vehicle, clean pipe thoroughly using a soft cloth and rubbing alcohol to remove any oil and finger prints.

The color of the exhaust will change once the system has gone through a heat cycle of 15 minutes or more. Color will vary depending on lean/rich conditions.

Clean using a soft cloth and soap. Do not use abrasive materials as it will scratch the surface.

Surface reconditioning services are available to remove scratches and undesirable discoloration due to extreme heat. Contact Yoshimura Tech Department at (800) 634-9166 / in CA (909) 628-4722 for more information.